

PERFORMANCE

Off^{the}Wall^{II} Storage Rack

Thank you for purchasing the Off The Wall II bicycle storage rack. This unique storage rack allows up to four bicycles (hardware for two is included) to be securely stored in any room with a level floor and a non-suspended ceiling or ceiling joist ranging from 7 to 10 feet high. No drilling or permanent attachment is necessary.

Note: Since your storage rack presses against a floor and a ceiling, it must be installed in an area with a solid (non suspended) ceiling.

The following parts are included with the Off The Wall II:

Part	Description	Qty.
A	Main body	1
B	Slider	1
C	Base/Cap plates	2
D	Bike holder arms	4
E	L-bracket assembly	1
F	5/8" Cap screw	8
G	Steel washers	8
H	Channel nuts	8
I	1/2" Cap screws	2
J	1 3/4" Cap screw	1
K	3/4" Sheet metal screws	4
L	Rubber pads	8
M	5/32" hex key	1
N	1 1/4" Sheet metal screws	2
O	Plastic threaded insert	2

Tools required:

5/32" hex key (included)

Phillips screwdriver

Assembly

1. Identify the end of the Main body(A) with 2 drilled holes (1 in each side channel). Thread a 3/4" Sheet metal screw (K) through one of the holes in the Main body and into the holes on the tabs of the Base plate (C) See **Figure 1**. Do not tighten yet. Repeat for the other tab of the Base plate. Tighten both of the 3/4" Sheet metal screws evenly, such that the tabs are centered within the Main body.

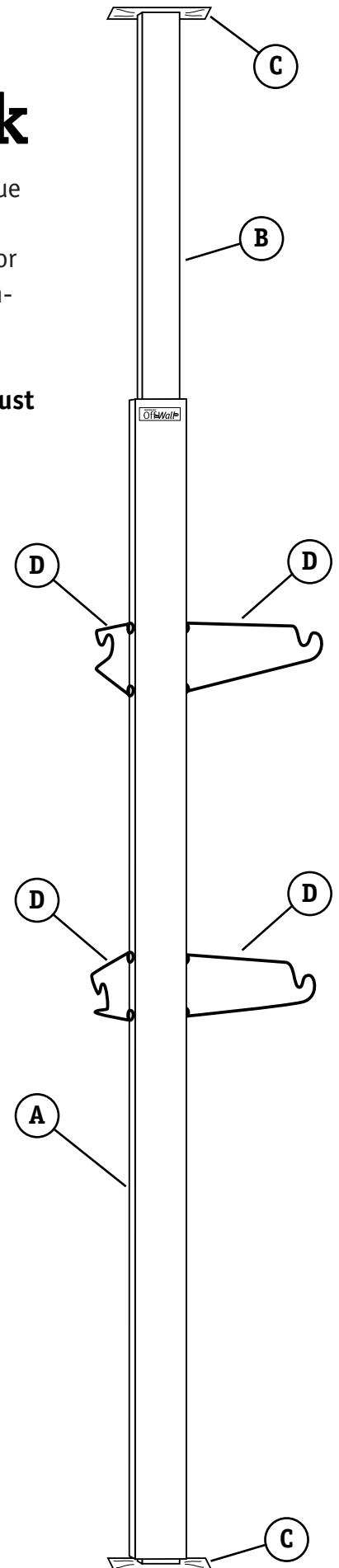
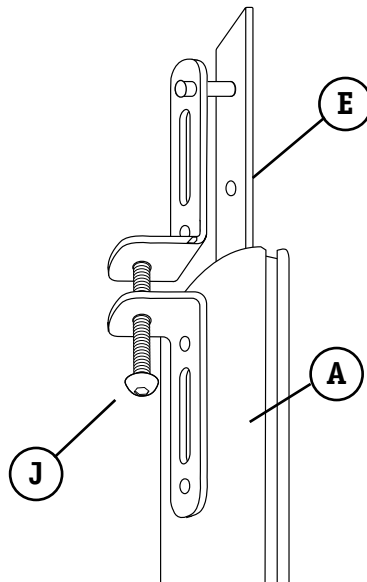

2. Identify the end of the Slider (B) with 2 drilled holes. Thread a $\frac{3}{4}$ " sheet metal screw through one of the holes in the Slider and into the hole on one of the tabs of the Cap plate (C). Do not tighten yet. Repeat for the other tab of the Cap plate. Tighten both of the $\frac{3}{4}$ " sheet metal screws evenly, such that the tabs are centered within the Slider.

3. Attach a Rubber pad (L) to each of the four corners of the Cap plate. Repeat for the Base plate. See **Figure 1**.

4. Insert the bar of the L bracket assembly (E) into the slider channel (B) as shown in **Figure 2**.

5. Insert the Slider (B) into the Main Body(A). Position the L-brackets such that the threaded holes are visible through the hole in the Main body L-bracket .

6. Loosely thread $\frac{1}{2}$ " Cap screws (I) into both of the L-brackets. The Slider should still be moveable inside the Main channel, so do not tighten yet. The L-bracket assembly should be on the back side (toward the wall) of the main body/slider assembly.

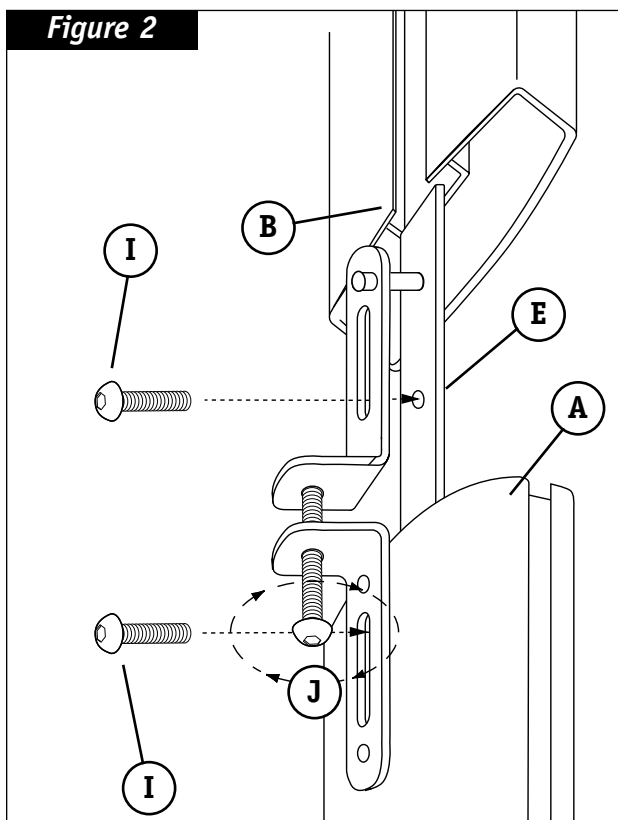
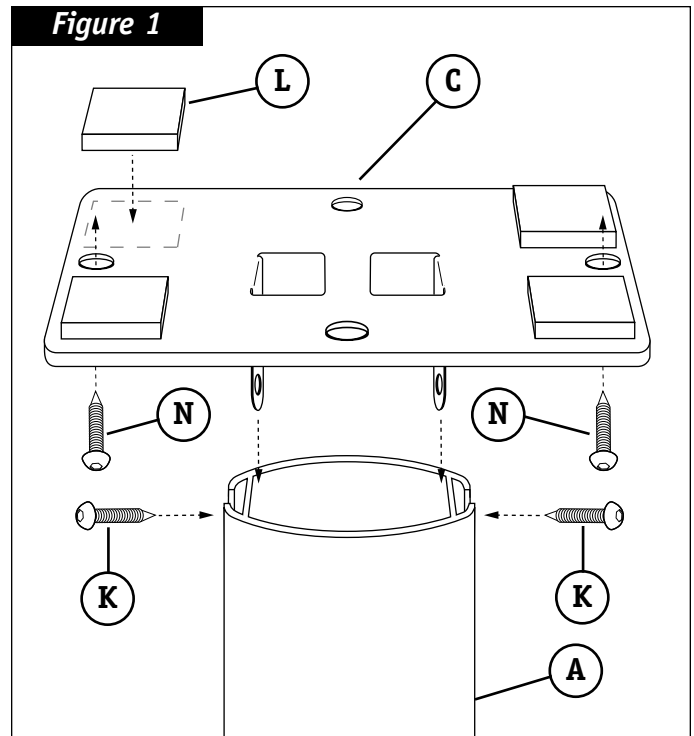

7. Thread the $1\frac{3}{4}$ " Cap screw (J) into the hole on the Main body L-bracket 5-6 turns. See **figure 2**.

8. Identify the 2 matched sets of Bike holder arms (D), 2 right and 2 left. Using the $\frac{5}{8}$ " Cap screws (F) and the Steel washers (G), loosely attach the Channel nuts (H) to the Bike holder arms as shown in **figure 3**. The Bike holder arms should protrude outward, away from the wall.

9. Slide the Bike holder arm assemblies into the channels on the side of the Main body. Position the lower and upper pairs of Bike holder arms approximately 34 inches and 75 inches respectively from the floor. Tighten cap screws (F) to secure the arms in place.

10. Position the Off The Wall II unit in the desired location with the Slider above the Main body as shown in **figure 4**. Extend the Slider upwards until the Cap

Figure 3

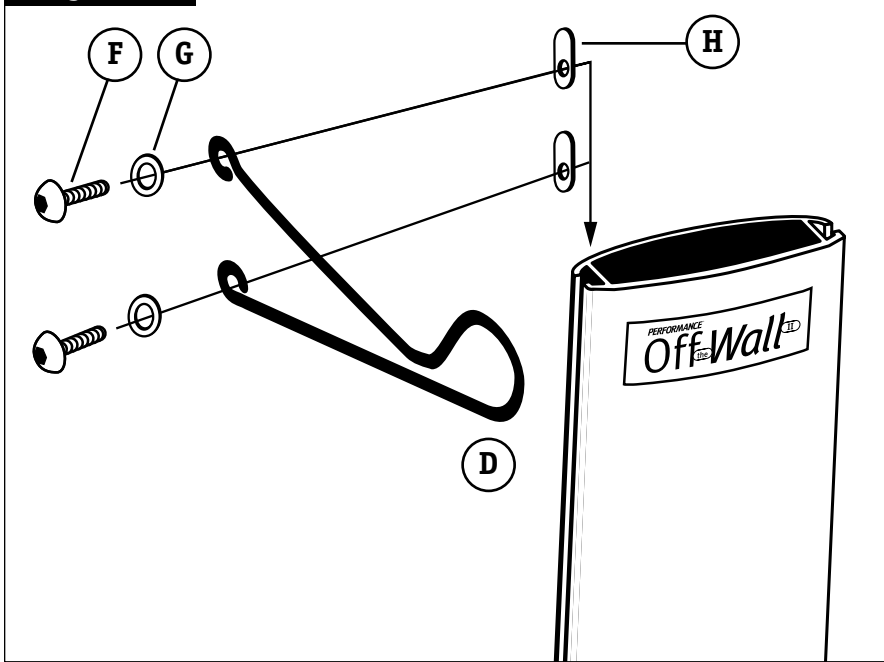

plate is firmly pressed against the ceiling. Using the hex key, securely tighten the $\frac{1}{2}$ " Cap screw (I) on the upper L-bracket assembly. Make sure that the unit is as vertical as possible by moving the top or bottom as needed. See **figure 4**.

11. Tighten the $\frac{3}{4}$ " Cap screw (J) with the hex key until the rack is firmly in place. Test the stability of the rack with moderate pushing and shaking.

Note: As you tighten Cap screw (J), it will press into the concave portion of the upper L-bracket. This further tightens the Cap plate against the ceiling.

12. Tighten the $\frac{1}{2}$ " Cap screw (I) on the lower L-bracket.

Warning: When using your Off the Wall II on a carpeted surface, be sure to apply enough pressure to completely compress the carpet and carpet pad.

13. For added stability, it is recommended that the top plate of the unit be fastened to the ceiling. When possible, mount the top plate to a ceiling joist using two screws (N), and one of the two sets of opposing holes in the top plate (depending on ceiling joist orientation). See figure 1.

14. If a ceiling joist cannot be located, use the screws (N) and wall plugs (O) to mount the top plate to the ceiling. Select one of the two sets of opposing holes, and use the top plate as a template to mark hole locations on ceiling. A $\frac{3}{16}$ " size hole is required for the wall plugs.

Figure 4

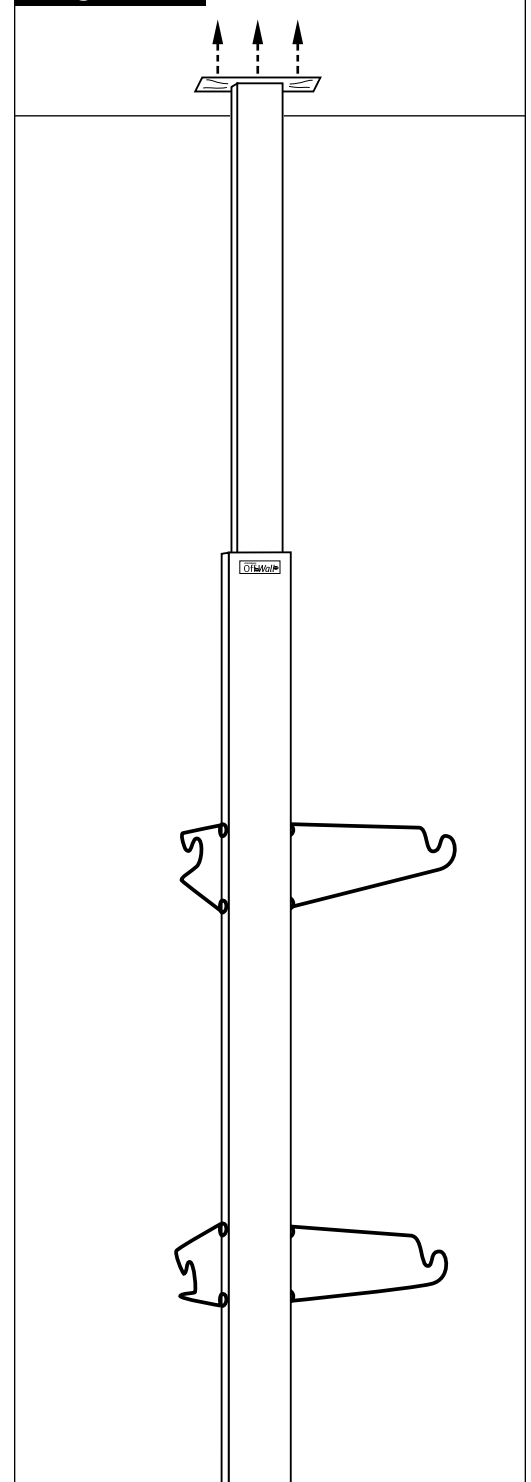

Continued on back

Continued...

15. Mount the bikes on the Bike holder arms and check to ensure clearance between the upper and lower bikes. Adjust as necessary and retighten the $\frac{5}{8}$ " Cap screws (F) on the Bike holder arms to secure their position.

Note: To store three or four bikes on your Off The Wall II storage unit, an extra mount kit, item #00-2280 is available.

Caution: Never extend the Off The Wall II beyond line marked on the slider.

Check the security of your rack 1-2 days after installing it. Re-adjust to compensate for any settling that may have occurred.

Call our Technical Service Department with any questions at 1-800-727-2453 (9am to 6pm EST)



Performance, Inc.
One Performance Way
Chapel Hill, NC 27514
www.performancebike.com
Made in USA