

PERFORMANCE[®]

ViewPoint[™] Single Owner's Manual

Thank you for purchasing a ViewPoint[™] Single light system. All ViewPoint[™] light systems are constructed of the highest quality materials, such as cold-forged aluminum housings, heavy duty cords with strong positive-click connections, and halogen bulbs with dichoric glass reflectors. Your ViewPoint[™] Single light system produces a clean light pattern for optimum visibility and is easily recharged for continued night riding enjoyment.

Please save these instructions, as they contain important information for taking care of your ViewPoint[™] Single light.

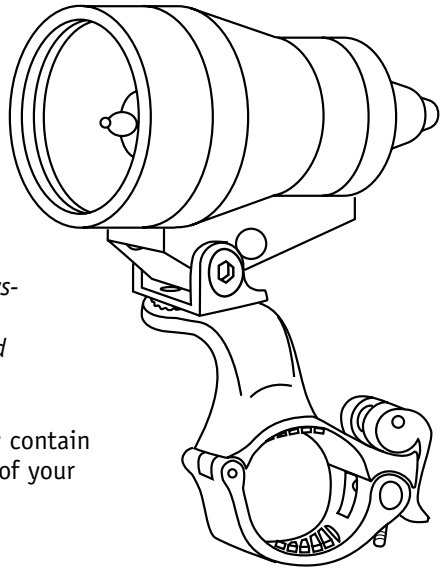

Installation and Use

Note: *Be sure to fully charge battery before first use (see the following section for details).*

1. Slide the battery into your waterbottle cage.
2. Install the headlight assembly onto your handlebar so that the headlight is positioned over the stem (see Figure 1).
3. Open the Quick Release Clamp, close the clamp around your bar, rotate the Quick Release Lever into position on the upper part of the clamp (with the lever pointing up) and then flip the Quick Release Lever downward to lock the clamp into position (see Figure 1).
4. If the clamp diameter setting is too loose or too tight, simply screw or unscrew the lever bolt as necessary to assure a secure grip on the bar.

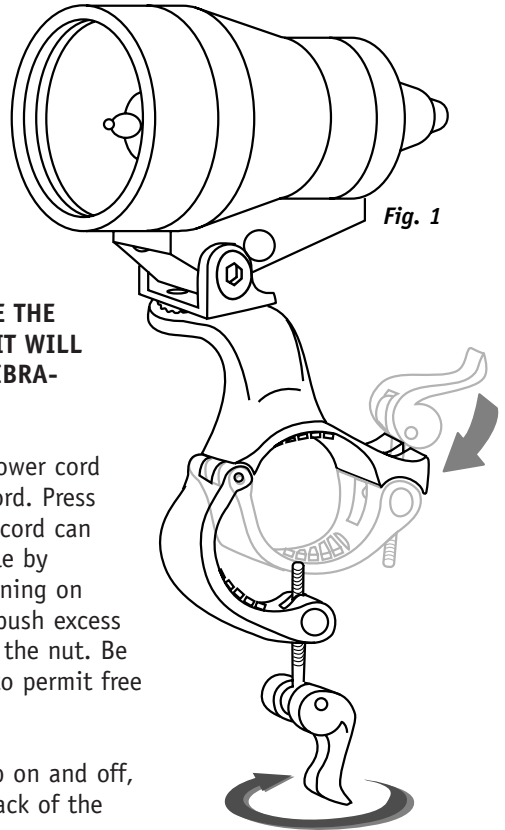

Fig. 1

5. Once you have your clamp tightness adjusted correctly, position your light as desired. **MAKE SURE THE CLAMP IS TIGHT ENOUGH THAT IT WILL NOT MOVE ON THE BAR FROM VIBRATION OR BUMPS.**
6. Connect the locking end of the power cord to the locking end of the light cord. Press firmly to snap into place. Excess cord can be stored inside the battery bottle by pushing it down through the opening on the top. Loosen the plastic nut, push excess cord into the bottle, and tighten the nut. Be sure to leave enough cord slack to permit free movement of the handlebars.
7. **To operate:** To turn the headlamp on and off, push the button switch on the back of the headlamp housing.
8. To remove the headlight assembly, flip the quick release upward and remove the entire assembly from your bike.

NOTE: The high wattage bulb causes the aluminum housing to get very hot when the light is in use. Therefore, DO NOT TOUCH ALUMINUM HOUSING WHILE THE LIGHT IS IN USE. Please use caution to avoid burning yourself. For optimum durability, your ViewPoint™ light should be mounted in such a way as to keep air flowing over the system.

Battery Charging

The ViewPoint™ battery must be recharged using *only* the 6 V, 400mA lead acid battery charger included with your light. Your ViewPoint™ light system uses a sealed lead acid battery. **It is extremely important that you always store your battery fully charged. A fully drained battery will be damaged beyond repair (this voids the warranty on the battery).** For the longest battery life, you should always recharge immediately after each use. ***Never use a NiCad or NiMH compatible charger on a sealed lead acid battery.***

1. Quick charge: Your battery can be charged to approximately 80% of its maximum charge in about 1 hour.
2. To guarantee a full recharge, leave the battery plugged in for 8 hours.

Your ViewPoint™ has a trickle charge feature which allows it to be left on recharge indefinitely, without harm.

Also available for your ViewPoint™ System

Battery upgrade for all ViewPoint™ Sealed Lead Acid systems

The lightweight, powerful Nickel Metal Hydride (NiMH) waterbottle style battery will provide a comparable run time at less than half the weight. It is compatible with any ViewPoint™ Single or Dual system. Please note that the charger supplied with this (Sealed Lead Acid) system will not work with the NiMH battery, so you *must* also order the charger if the battery is to be used as an upgrade.

- 40-0323 NiMH 4.0 Ahr battery (requires NiMH battery charger)
- 40-0339 NiMH battery charger (only for use with NiMH battery)
- 40-0332 Helmet mount kit
- 40-0320 Sealed lead acid 4.0 Ahr battery waterbottle style (replacement battery for ViewPoint™ Single)
- 40-0321 Sealed lead acid 5.0 Ahr battery waterbottle style (replacement battery for ViewPoint™ Dual, longer run time but same physical dimensions as ViewPoint™ Single battery)
- 00-2365 12-watt flood bulb (30° beam)
- 00-8152 12-watt spot bulb (10° beam)
- 40-0026 15-watt intermediate bulb (20° beam)
- 00-8154 20-watt flood bulb (30° beam)

Bulb Replacement – Read Carefully!

Take care when replacing the lamp in order not to damage the bulb connection.

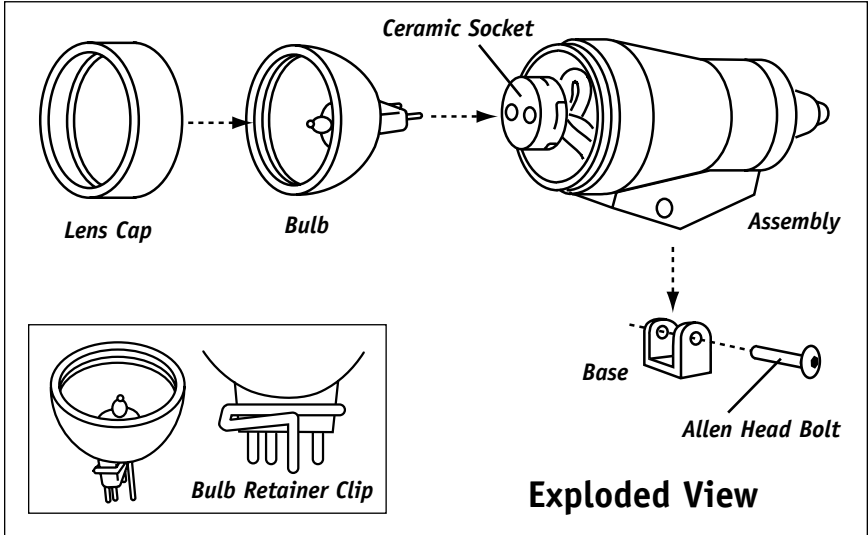

1. Disconnect headlamp from battery pack.
2. To remove the bulb, carefully unthread the lens cap. Do not allow the bulb to rotate. It may be necessary to press down gently on the bulb while unthreading the cap.
3. Unplug the used bulb and discard it.
4. To install the bulb, first insert the two prongs of the retainer clip into the larger holes on the ceramic socket. Next, insert the bulb lead wires into the smaller holes in the socket.
5. Rethread lens cap onto housing. Make sure the lens cap thread is fully engaged with the housing. Do not plug the lamp into the battery until after this step is complete.

For technical support, call 1-800-727-2453 from 9am - 6pm Monday through Friday.



Performance, Inc.

One Performance Way
Chapel Hill, NC 27514

www.performancebike.com

1-800-727-2453