

Tech Support Line
1-800-727-2453
1002_1

installation

Quattro lens installation

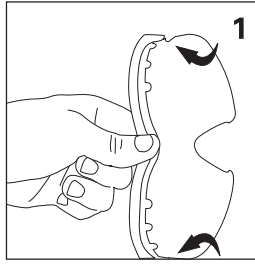

Step 1
Install the left and right corners of the lens in the frame.

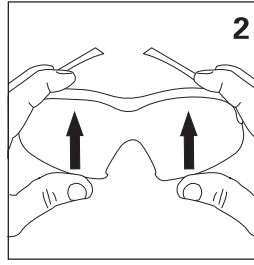

Step 2
Insert the top edge of the lens into the frame.

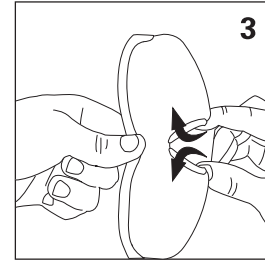

Step 3
From behind the lens, grip the nose pieces with your finger and thumb. Gently squeeze them together, and bring them forward until they snap around the edge of the lens.

Tech Support Line
1-800-727-2453
1002_1

removal

Quattro lens removal

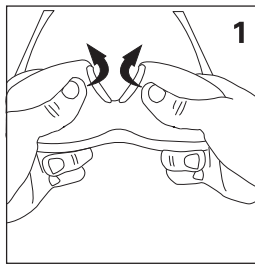

Step 1
Holding the glasses upside down, use your thumbs to gently press the nose pieces together and away from you until they are resting behind the lens.

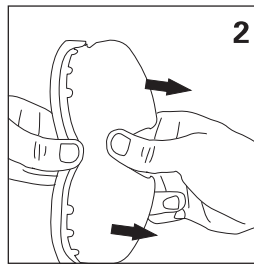

Step 2
With the nose pieces resting behind the lens, grip the lens near the center and gently pull down to remove the top edge of the lens from the frame.

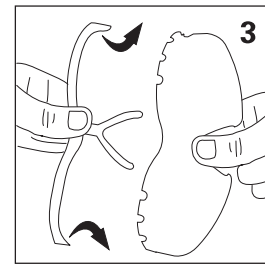

Step 3
The left and right corners of the lens can then be removed from the frame.