

keylines do not print
art @ 100%

Tech Support Line
1-800-727-2453
20-1651 0603_1

removal

Procyon lens removal

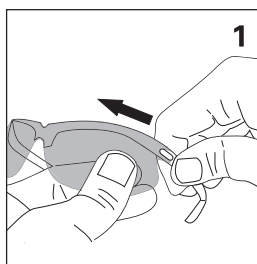

Step 1
Hold the frame near the hinge while grasping the lower/outer edge of the lens.

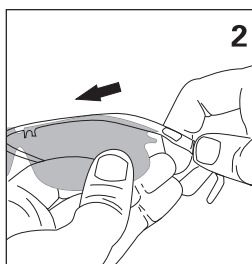

Step 2
Flex and pull the lens gently to detach it from beneath the tab located near the hinges.

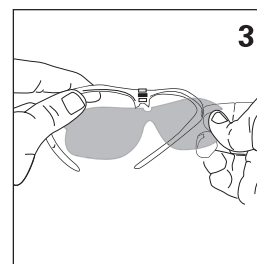

Step 3
Pivot the entire lens upward to release it from the lower of the two center tabs.

Tech Support Line
1-800-727-2453
20-1651 0603_1

installation

Procyon lens installation

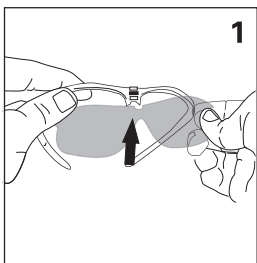

Step 1
Hold the frame near the hinge while grasping the center tabs.

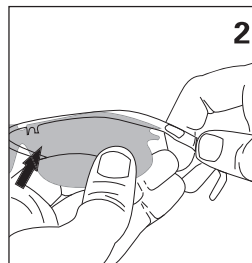

Step 2
Insert the upper edge of the lens under the upper of the two center tabs. Pivot the entire lens downward, push in the center of the lens until it pops under the lower of the two center tabs.

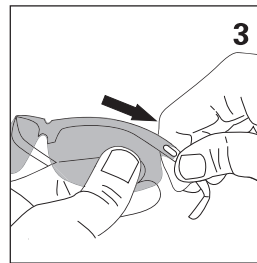

Step 3
Flex and push the lens gently to insert each of the ends beneath the hinges.