

Tech Support Line
1-800-553-8324
20-2212 0205_1

installation

Dorado lens installation

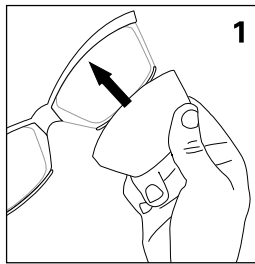

Step 1
Hold the frame near the center while grasping the lower edge of the lens.

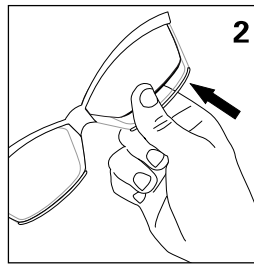

Step 2
Insert the upper edge of the lens into the channel in the upper portion of the frame.

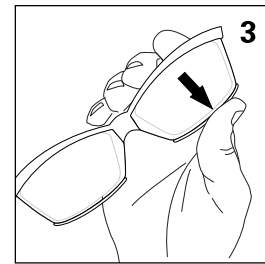

Step 3
Pivot the lower edge of the lens inward. Push on the bottom of the lens until it pops into the channel in the lower portion of the frame.

Tech Support Line
1-800-553-8324
20-2212 0205_1

removal

Dorado lens removal

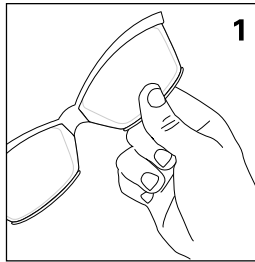

Step 1
Hold the frame near the center while grasping the lower portion of the lens.

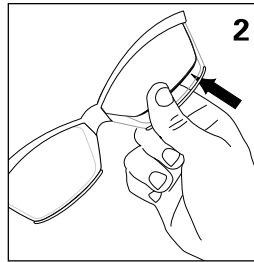

Step 2
Push and pivot the lower edge of the lens gently forward until it pops out of the channel in the lower portion of the frame.

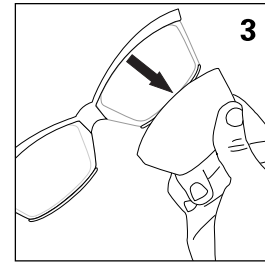

Step 3
Detach the lens from the frame and store it in a safe place.