





HurricaneTM



*Retractable hose protects
valve stem while pumping*



*Floor-pump action allows easy inflation
to high pressures (120+ psi)*



*Folding "T" handle
provides better leverage*



*Universal bracket mounts
to any size frame tube*



*Quickly converts for
Presta or Schraeder valves*



196g



**mini
max**

INSTRUCTIONS FOR TIRE INFLATION:

1. Identify valve type. Remove threaded cap and position rubber gasket and plastic pin as needed. See Figure 1.

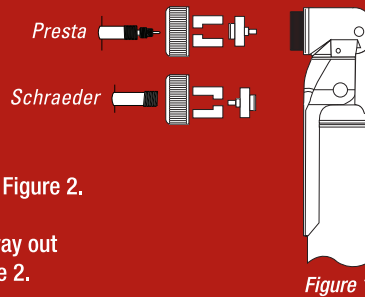

2. Lift thumb lock lever to the locked position. See Figure 2.

3. Rotate pump head 90°, pull pump head all the way out of base and release thumb lock lever. See Figure 2.

4. Remove dust cap from tire valve. For Presta valves, unscrew metal locking barrel at tip of valve. Depress tip of either type valve to ensure valve doesn't stick and to blow out any dirt or contaminants.

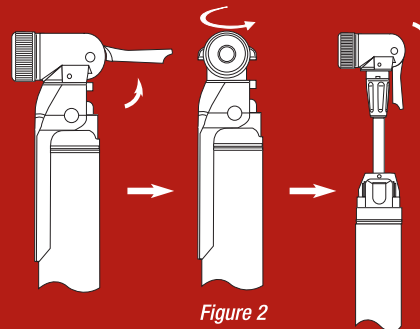

5. Press pump head onto tire valve stem as far as it will go, lift thumb lock lever to the "locked" position, and fold down foot peg to the open position. See Figure 3.

6. Inflate tire to desired pressure. Do not inflate beyond maximum recommended inflation pressure printed on tire sidewall.

7. Release thumb lock lever and remove pump head from valve stem.

8. For Presta valves, screw down locking barrel at valve tip. Replace valve stem dust cap.

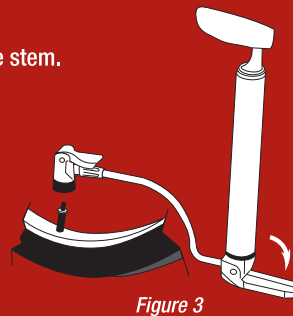

BRACKET INSTALLATION:

1. Attach bracket clamp to frame tube and tighten adjusting screw to secure in place.

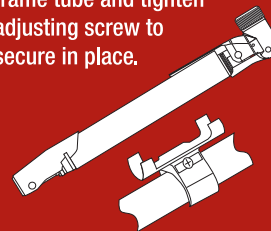

40-0762



Made in Taiwan

