

## Heavy Duty U-lock

1. Mount the bracket to the bicycle's seat tube as shown in either Figure A or Figure B.
2. With the lock inserted into the bracket, tighten the cam lever nut against the bracket so that when the cam lever is closed (Figure C) the lock is held securely in the bracket.

**A**

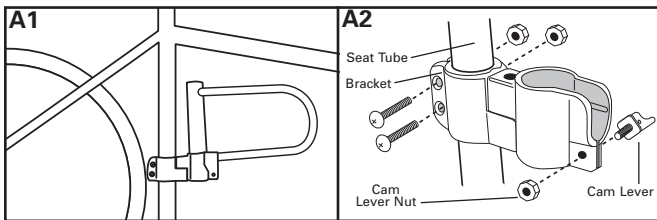

**B**

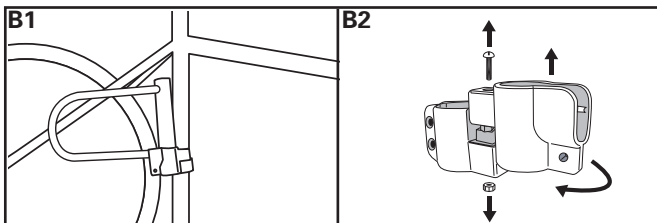

**B3**

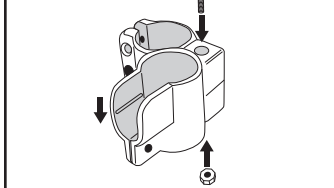

**B4**

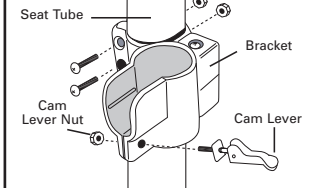

**C**

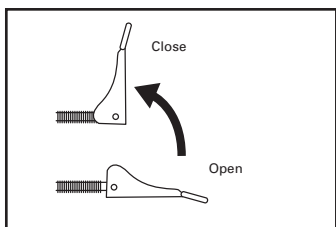

Performance, Inc.  
One Performance Way  
Chapel Hill, NC 27514  
PerformanceBike.com  
Made in Taiwan

PERFORMANCE and the flying P are registered marks of Performance Inc.

0302-1

Call our Technical Service Department  
with any questions at 1-800-727-2453 (9am to 6pm EST)

## Heavy Duty U-lock

1. Mount the bracket to the bicycle's seat tube as shown in either Figure A or Figure B.
2. With the lock inserted into the bracket, tighten the cam lever nut against the bracket so that when the cam lever is closed (Figure C) the lock is held securely in the bracket.

**A**

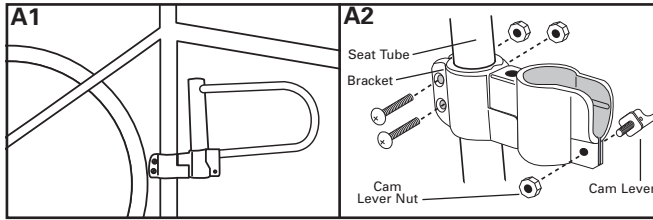

**B**

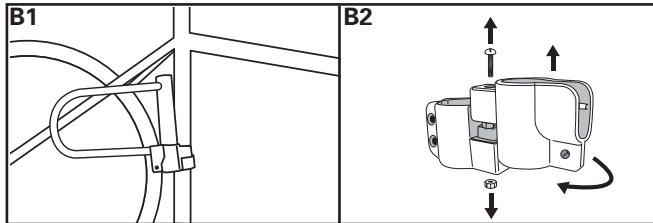

**B3**

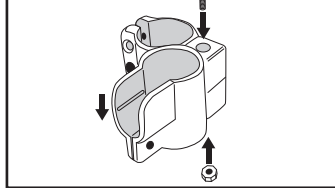

**B4**

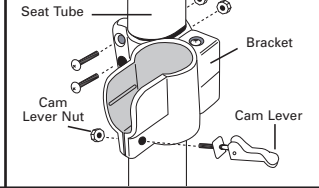

**C**

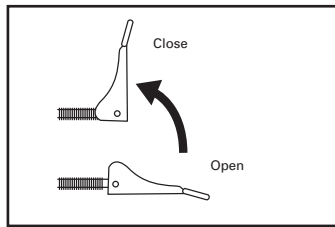

Performance, Inc.  
One Performance Way  
Chapel Hill, NC 27514  
PerformanceBike.com  
Made in Taiwan

PERFORMANCE and the flying P are registered marks of Performance Inc.

0302-1

Call our Technical Service Department  
with any questions at 1-800-727-2453 (9am to 6pm EST)

## Heavy Duty U-lock

1. Mount the bracket to the bicycle's seat tube as shown in either Figure A or Figure B.
2. With the lock inserted into the bracket, tighten the cam lever nut against the bracket so that when the cam lever is closed (Figure C) the lock is held securely in the bracket.

**A**

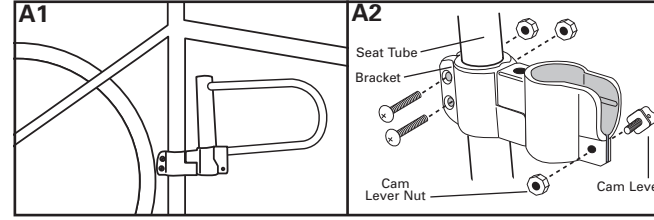

**B**

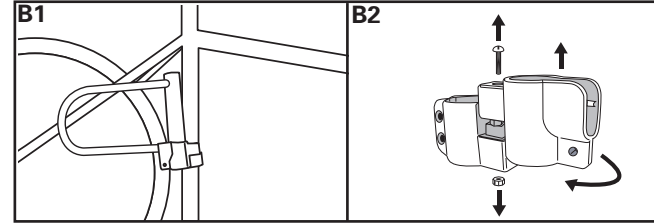

**B3**

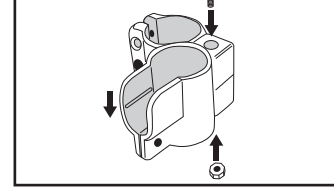

**B4**

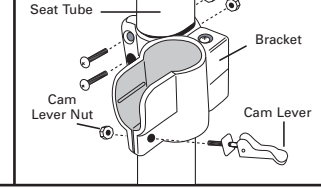

**C**

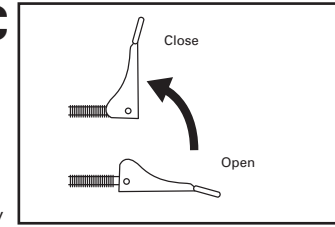

Performance, Inc.  
One Performance Way  
Chapel Hill, NC 27514  
PerformanceBike.com  
Made in Taiwan

PERFORMANCE and the flying P are registered marks of Performance Inc.

0302-1

Call our Technical Service Department  
with any questions at 1-800-727-2453 (9am to 6pm EST)