

XPORT

frame adapter



*Thank you for your purchase of an XPORT Frame Adapter.
Please read these instructions carefully before use.*

XPORT

frame adapter



*Thank you for your purchase of an XPORT Frame Adapter.
Please read these instructions carefully before use.*

Installation

1. Ensure that the bicycle saddle is securely attached to the seatpost, and the seatpost is securely installed in the bicycle frame before using the XPORT Frame Adapter.
2. Press the snap-buttons at each end of the frame adapter to open the hooks. See Figure 1.
3. Place the smaller hook around the bicycle seatpost and close the hook. See Figure 2. Ensure the snap-button is fully engaged.
4. Pull on the larger hook to extend the frame adapter tube, and secure the larger hook around the bicycle stem. Close the hook and ensure the snap-button is fully engaged. See Figure 3.
5. The bicycle can now be attached to a hitch mounted or trunk mounted bicycle carrier, using the frame adapter as the mounting point. See Figure 4.

⚠ CAUTION

When attaching frame adapter to bicycle, ensure snap-buttons are fully engaged, and bicycle is securely attached to vehicle rack. An improperly secured bicycle may fall, causing personal injury and damage to the bicycle, your vehicle or vehicles following behind you on the road.

⚠ CAUTION

Maximum bicycle weight: 32 lbs. Not intended for use on bicycle carriers attached to a towed vehicle or trailer.

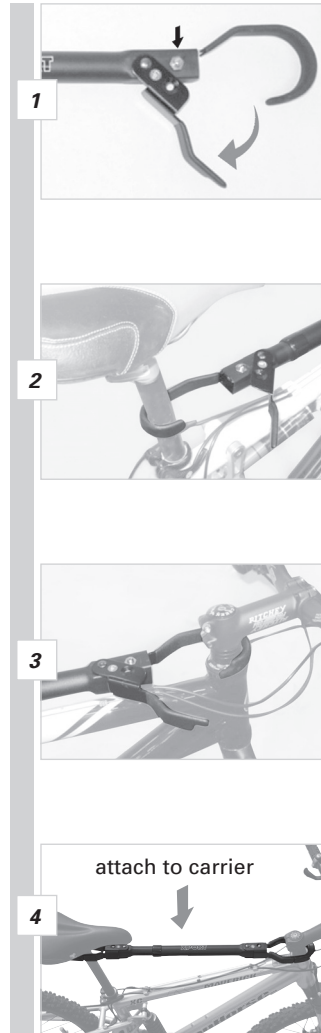

Installation

1. Ensure that the bicycle saddle is securely attached to the seatpost, and the seatpost is securely installed in the bicycle frame before using the XPORT Frame Adapter.
2. Press the snap-buttons at each end of the frame adapter to open the hooks. See Figure 1.
3. Place the smaller hook around the bicycle seatpost and close the hook. See Figure 2. Ensure the snap-button is fully engaged.
4. Pull on the larger hook to extend the frame adapter tube, and secure the larger hook around the bicycle stem. Close the hook and ensure the snap-button is fully engaged. See Figure 3.
5. The bicycle can now be attached to a hitch mounted or trunk mounted bicycle carrier, using the frame adapter as the mounting point. See Figure 4.

⚠ CAUTION

When attaching frame adapter to bicycle, ensure snap-buttons are fully engaged, and bicycle is securely attached to vehicle rack. An improperly secured bicycle may fall, causing personal injury and damage to the bicycle, your vehicle or vehicles following behind you on the road.

⚠ CAUTION

Maximum bicycle weight: 32 lbs. Not intended for use on bicycle carriers attached to a towed vehicle or trailer.

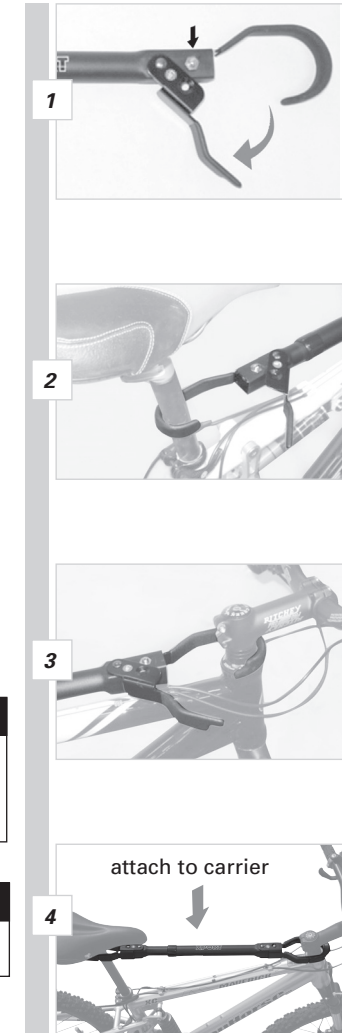

Tech Support 1(800)553-8324

Tech Support 1(800)553-8324