

PERFORMANCE®

SPIN DOCTOR® star nut installer

Assembly

1. Assemble tool as shown. Use shim for 1" steerer tubes. Star nut is included with fork or headset.
2. Carefully align star nut in top of steerer tube, and use a hammer on punch to force star nut into steerer tube.

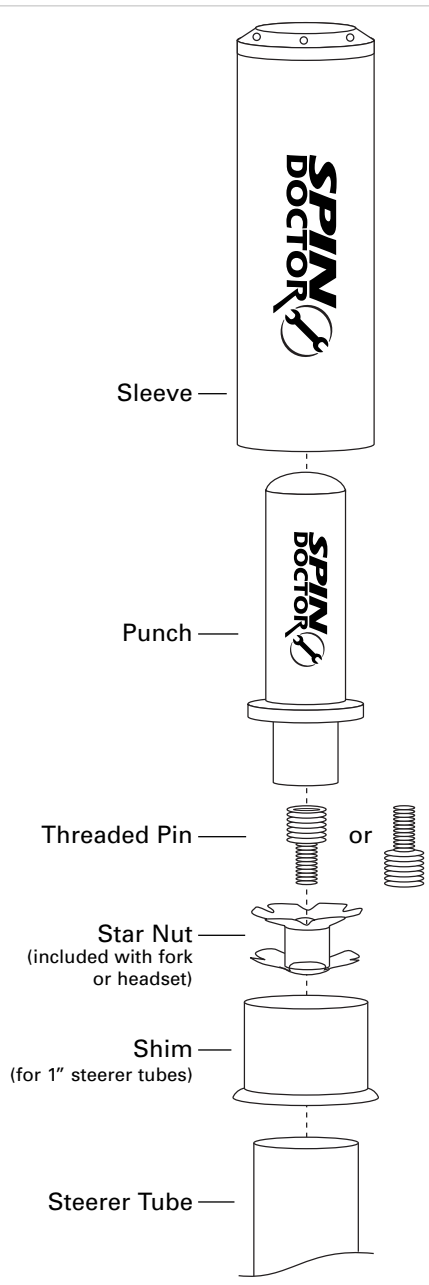

Performance Tech Support
1(800)553-8324

9am-10pm EST Monday-Friday
12pm-6pm Saturday-Sunday



Performance, Inc.
One Performance Way
Chapel Hill, N.C. 27514
Made in Taiwan

www.performancebike.com

PERFORMANCE and the Flying P Logo are registered marks of Performance, Inc.

40-2196 1104_1

PERFORMANCE®

SPIN DOCTOR® star nut installer

Assembly

1. Assemble tool as shown. Use shim for 1" steerer tubes. Star nut is included with fork or headset.
2. Carefully align star nut in top of steerer tube, and use a hammer on punch to force star nut into steerer tube.

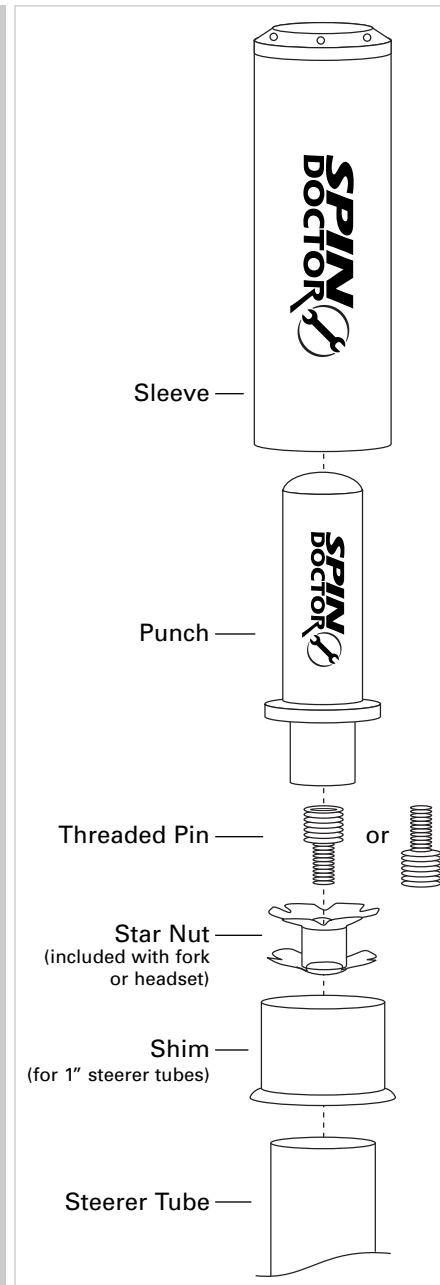

Performance Tech Support
1(800)553-8324

9am-10pm EST Monday-Friday
12pm-6pm Saturday-Sunday



Performance, Inc.
One Performance Way
Chapel Hill, N.C. 27514
Made in Taiwan

www.performancebike.com

PERFORMANCE and the Flying P Logo are registered marks of Performance, Inc.

40-2196 1104_1