

# XPORT

## FLATBED™

### 4-bike hitch rack



*Thank you for your purchase of an XPORT™ hitch rack. The XPORT™ Flatbed will securely carry up to 4 bicycles, and tilts down to allow convenient access to the rear of your vehicle. Please read these instructions thoroughly before using your new hitch rack.*

#### ⚠ CAUTION

IT IS THE USER'S RESPONSIBILITY TO ENSURE THE SAFE AND PROPER USE OF THIS PRODUCT. Improper attachment or misuse of this product may result in personal injury and serious damage to the bicycles, the hitch rack, your vehicle or vehicles following behind you on the road.

Tech Support 1(800)553-8324

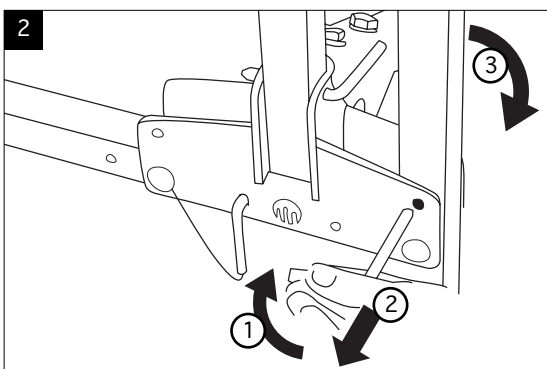
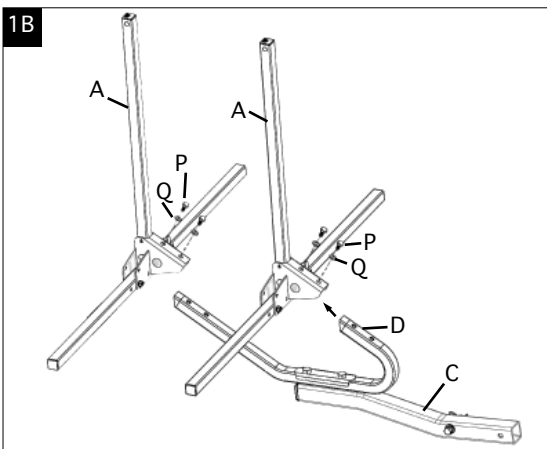
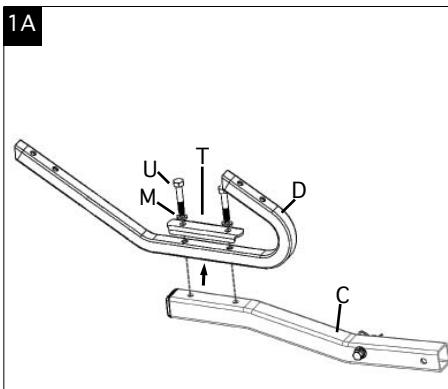
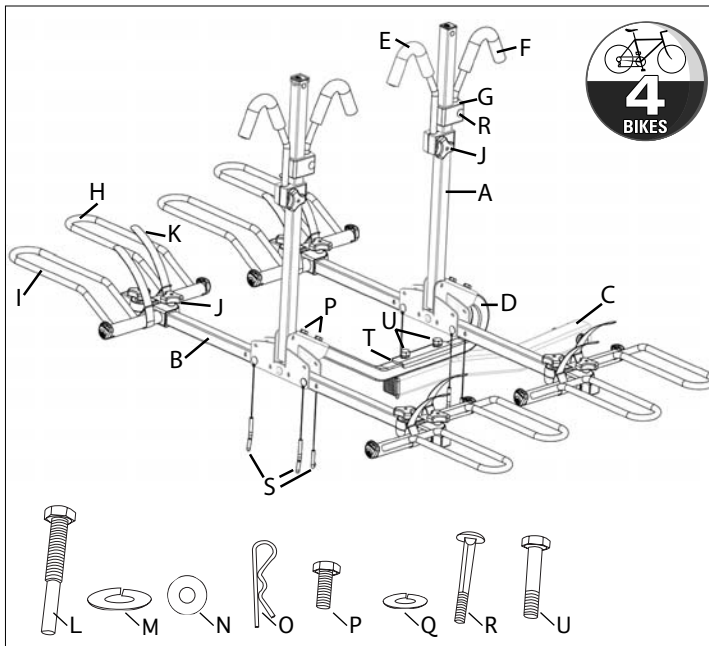

**Maximum Bicycle Limit:**

4 bicycles

**Maximum Load Limit:**

35 lbs. per bicycle (140 lbs total)

**CAUTION**  
Do not exceed the maximum bicycle limit or maximum load limit listed in this owner's manual. Consult vehicle owner's manual to determine maximum tongue weight (TW) for vehicle. Do not use rack if combined weight of rack (72 lbs) and bicycles exceeds vehicle's maximum tongue weight.

**I. Parts List**

Part	Part Code	Quantity
Upright Tube .....	A .....	2
Platform Tubes .....	B .....	4
Hitch Tube .....	C .....	1
Connection Tube .....	D .....	1
Long Frame Hook .....	E .....	2
Short Frame Hook .....	F .....	2
Frame Hook Bracket .....	G .....	4
Wheel Hoops .....	H .....	4
Wheel Hoops .....	I .....	4
Locking Knobs .....	J .....	12
Wheel Straps .....	K .....	8
Hitch Bolt .....	L .....	1
Large Slotted Washer .....	M .....	3
Large Flat Washer .....	N .....	1
Pin Clip .....	O .....	1
Hitch Tube Assembly Bolts .....	P .....	4
Small Slotted Washers .....	Q .....	4
Frame Hook and Wheel Hoop Assembly Bolts .....	R .....	12
Securing Pins .....	S .....	6
Connection Bracket .....	T .....	1
Connection Tube Assembly Bolts .....	U .....	2

**II. Assembly**

**CAUTION**  
Assemble and install rack using hand tools only. Do not over tighten. Do not use power or pneumatic tools.

**Assembling the Hitch Rack**

*Note: All references to left or right are from the driver's perspective.*

1. Remove the hitch rack and all other contents from the box.
2. Attach the connection tube (D) to the hitch tube (C) using the connection bracket (T), assembly bolts (U) and slotted washers (M) as shown in Figure 1a. Tighten the bolts securely.
3. Remove the platform securing pins (S) from the platform tubes (B), fold down the left and right platform tubes and replace the securing pins. See Figure 2.
4. To attach the upright tubes (A) to the connection tube (D), slide the ends of the connection tube into the brackets at the base of each upright tube (A). See Figure 1b. Thread the assembly bolts (P) with washers (Q) through the bolt holes, and tighten securely. See Figure 3.
5. Assemble the frame hooks (E and F) as shown in Figures 4a, 4b and 4c.

6. Slide the long frame hooks (E) onto the upright tubes with the hooks facing away from the vehicle and tighten in place with the locking knobs (J). See Figure 5.
7. Slide the short frame hooks (F) onto the upright tubes with the hooks facing the vehicle and tighten in place with the locking knobs (J).
8. Assemble the wheel hoops (H and I) as shown in Figures 6a and 6b.
9. Slide the wheel hoops onto the platform tubes (B) as shown in Figure 7.

**Installing the Hitch Rack**

1. Slide the hitch tube into the vehicle receiver hitch and align the bolt hole in the receiver hitch with the bolt hole in the hitch tube. See Figure 8.
2. Slide the slotted (M) and flat (N) washers onto the hitch bolt (L), thread the bolt through the receiver hitch and hitch tube, and tighten securely.
3. Press the pin clip (O) through the hole in the protruding end of the hitch bolt.

**III. Using the Hitch Rack**

**Loading the Bicycles**

1. Remove the upright securing pins (S) and lower the upright tubes (A). See Figure 9.
2. The first bicycle will be positioned closest to the vehicle. Lift the bicycle into place, and set the front and rear wheels into the wheel hoops (H and I). Each wheel should be well supported by both ends of each hoop. See Figure 10.
3. Reposition the wheel hoops as necessary until both wheels are well supported. Loosen the locking knobs (J), slide the wheel hoops left or right along the platform tube, and re-tighten the locking knobs securely.
4. Raise the upright tube and slide the frame hook (F) down until it presses firmly against the bicycle's top frame tube; then tighten the locking knob (J) securely. See Figure 11. For bicycles with sloping top tubes, position the bicycle so the hook is as low on the sloping tube as possible. See Figure 12.
5. Replace the upright securing pin and rotate it clockwise as far as it will go. See Figure 13.
6. Lift the second bicycle into place. Adjust the position of the wheel hoops as necessary so that both wheels are well supported and tighten the locking knobs. Slide the frame hook down until it presses firmly against bicycle's top frame tube; then tighten the locking knob securely.
7. Secure the wheels of both bicycles with the hook and loop straps at the end of each wheel hoop. See Figure 14.
8. Load the third and fourth bicycles in the same way, securing them as described above.
9. Once all bicycles are secure, make sure no part of any bicycle can contact and potentially scratch or otherwise damage the vehicle.

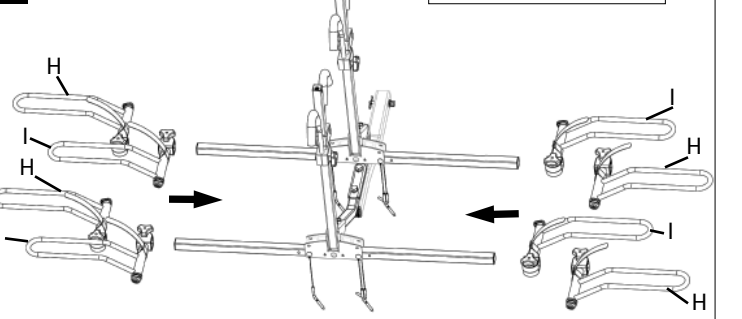
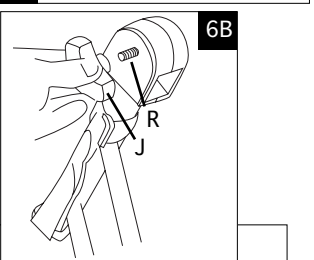
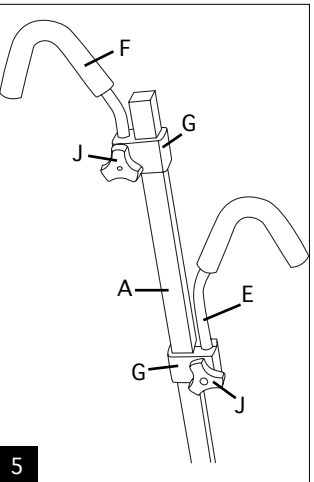
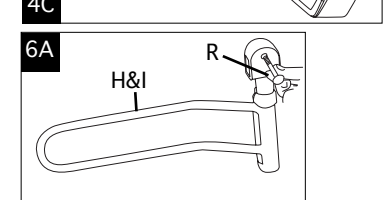
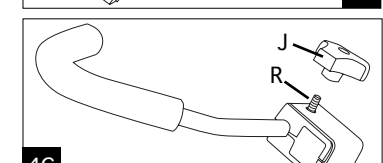
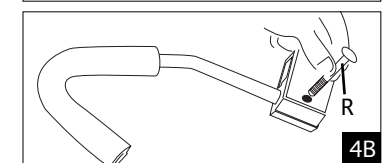
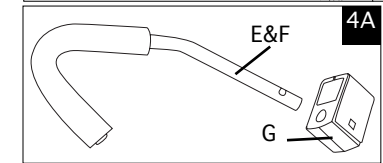
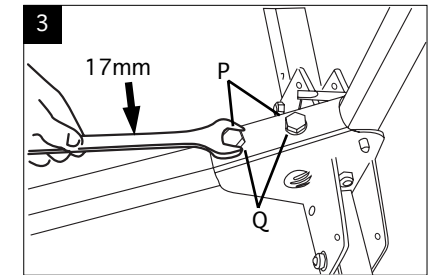

**CAUTION**

**FOR SAFE AND PROPER USE OF YOUR HITCH RACK:**

1. Keep bicycle tires clear of the exhaust pipe. Hot exhaust can melt or burn bicycle tires.
2. Inspect your hitch rack before each use, both before and after loading bicycles. Ensure all bolts, knobs, clevis pins and pin clips are installed and tightened properly.
3. Make sure no part of the bicycles or rack can contact and potentially scratch or otherwise damage the vehicle.
4. Check security of all bikes at regular intervals during use, more frequently on bumpy roads, and immediately if the bicycles shift position.
5. Never exceed maximum bicycle limit or load limit listed in this owner's manual, or vehicle's maximum tongue weight listed in vehicle owner's manual.
6. Remove the hitch rack from vehicle when not in use.