

SPIN DOCTOR

universal star nut installer

Assembly

1. Assemble tool as shown. Use the large shim for 1 1/8" steerer tubes or both shims for 1" steerer tubes.
2. Thread star nut onto the threaded pin. Star nut is included with headset or fork.
3. Align star nut on top of the steerer tube, slide the sleeve over the punch, and use a hammer on the punch to force the star nut into the steerer tube.

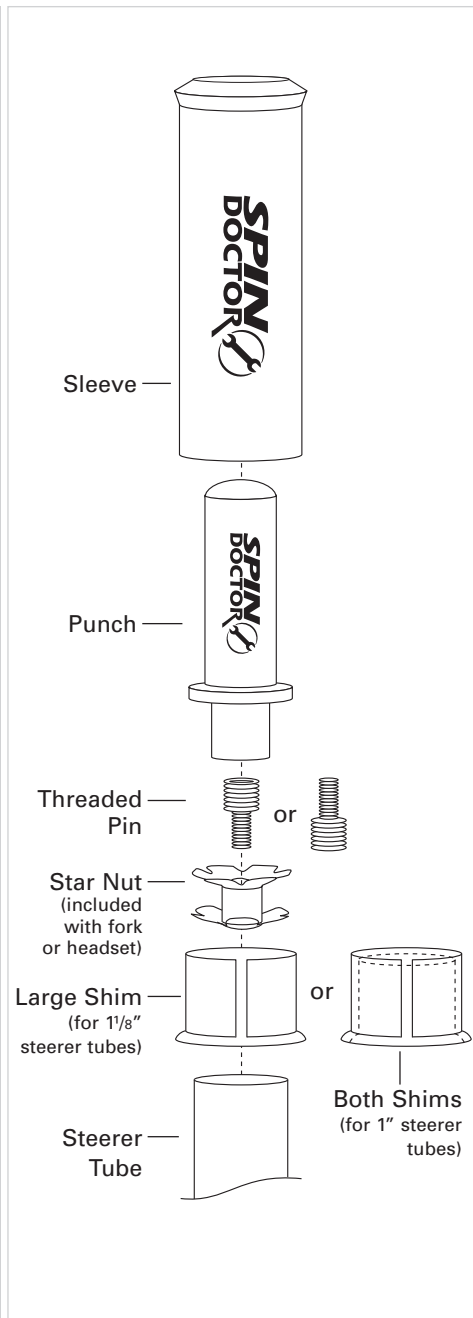

Tech Support 1(800)553-8324

SPIN DOCTOR

universal star nut installer

Assembly

1. Assemble tool as shown. Use the large shim for 1 1/8" steerer tubes or both shims for 1" steerer tubes.
2. Thread star nut onto the threaded pin. Star nut is included with headset or fork.
3. Align star nut on top of the steerer tube, slide the sleeve over the punch, and use a hammer on the punch to force the star nut into the steerer tube.

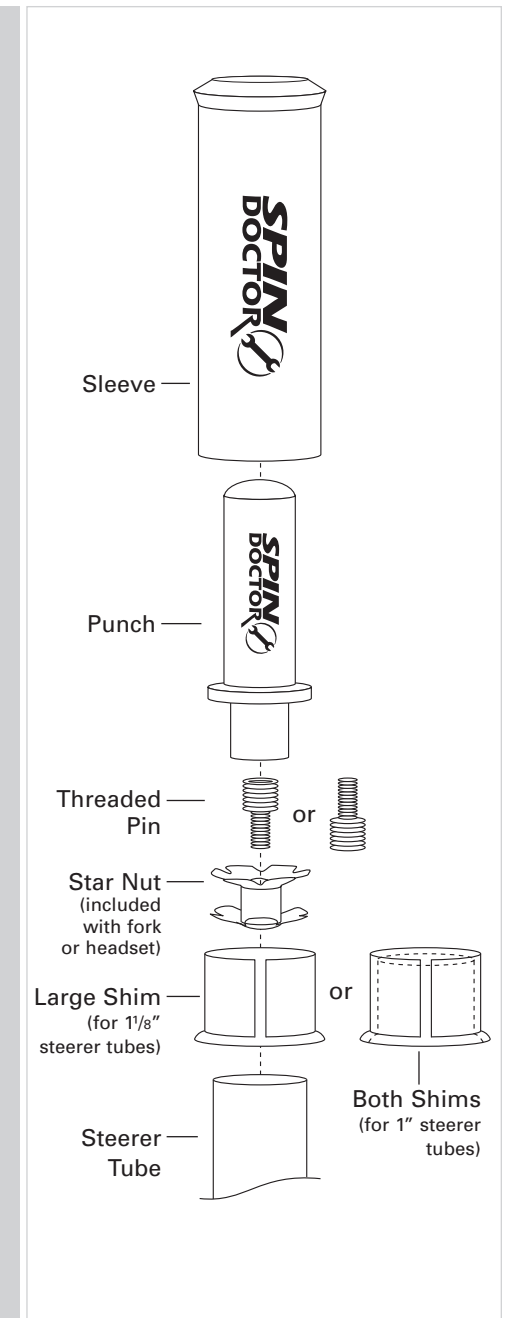

Tech Support 1(800)553-8324