

LENS CHANGE INSTRUCTIONS

MATRIX

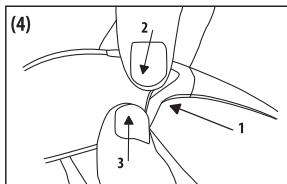
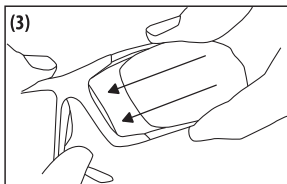
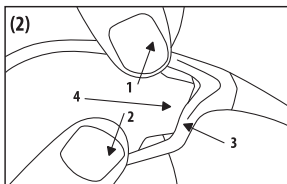
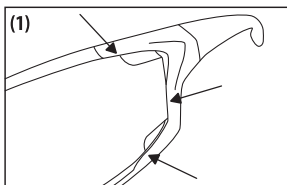

Removing the lenses:

The lens is held in place by the three points as shown [image #1]. Using your thumbs, release these frame points from the "lens" tabs by pushing the lens through "the frame" with your index fingers until the frame points (#1, #2, and #3) release the lens. Slide lens to the outside (#4) and out [image #2].

Inserting the lenses:

Slide the lens into the lens channels closest to the bridge area as shown [Image #3]. Once the lens is set at the bridge area, work the points of the lens into the channels at the outside edges of the frame starting with #1, then #2 then #3 until the lens is securely seated into the frame [image #4].

Tech Support Line
1.800.888.2710



SCATTANTE
MATRIX