



Bar Ends

INTRODUCTION

Congratulations on your purchase of the Ascent Bar Ends. These light-weight, anatomic bar ends will improve your confidence, control and comfort on every ride.

INSTALLATION

STEP 1

Expose half an inch of each end of the handlebar either by moving the grips inward or by cutting off the ends of the grips (see fig. 1). Ensure that the handlebar mounting surface is clean. Ensure that the inner surface of the bar end clamp is free of burrs. Grease clamp bolts.

STEP 2

Install your Bar Ends on the ends of your handlebar with the clamps facing down and the extensions facing forward and angling inward. An angle of 10° to 30° from horizontal is recommended as a good initial setting, but each rider should adjust according to personal preference (see fig. 2). Tighten bolts. Check tightness of the bar ends by stabilizing the front wheel between your legs and attempting to rotate bar ends. The bar ends should not rotate without substantial force.

STEP 3

Cap the ends of your handlebar with the provided plugs.

CAUTION

When installing bar ends on a carbon fiber handlebar, consult the handlebar manufacturer's instructions. Some bar ends may not be suitable for use with some carbon fiber handlebars.

CAUTION

If you are unsure whether these bar ends are compatible with your handlebar, or to ensure that you have installed the bar ends correctly, consult a professional bike mechanic.

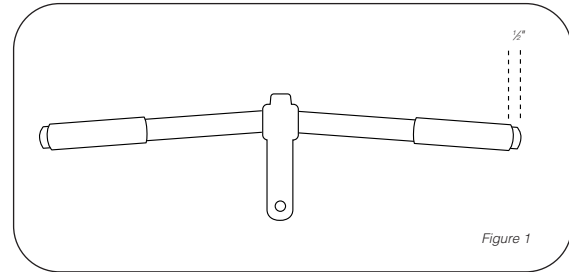

Figure 1

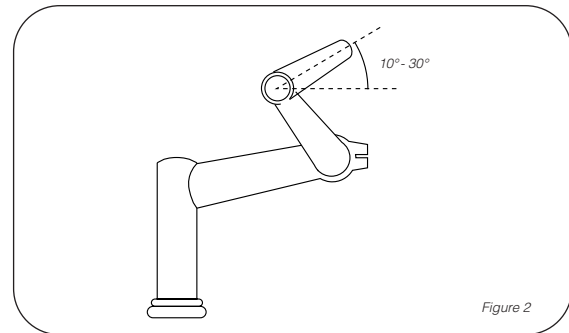

Figure 2



Chapel Hill, NC

Made in Taiwan, V.1 – May 2002



Bar Ends

INTRODUCTION

Congratulations on your purchase of the Ascent Bar Ends. These light-weight, anatomic bar ends will improve your confidence, control and comfort on every ride.

INSTALLATION

STEP 1

Expose half an inch of each end of the handlebar either by moving the grips inward or by cutting off the ends of the grips (see fig. 1). Ensure that the handlebar mounting surface is clean. Ensure that the inner surface of the bar end clamp is free of burrs. Grease clamp bolts.

STEP 2

Install your Bar Ends on the ends of your handlebar with the clamps facing down and the extensions facing forward and angling inward. An angle of 10° to 30° from horizontal is recommended as a good initial setting, but each rider should adjust according to personal preference (see fig. 2). Tighten bolts. Check tightness of the bar ends by stabilizing the front wheel between your legs and attempting to rotate bar ends. The bar ends should not rotate without substantial force.

STEP 3

Cap the ends of your handlebar with the provided plugs.

CAUTION

When installing bar ends on a carbon fiber handlebar, consult the handlebar manufacturer's instructions. Some bar ends may not be suitable for use with some carbon fiber handlebars.

CAUTION

If you are unsure whether these bar ends are compatible with your handlebar, or to ensure that you have installed the bar ends correctly, consult a professional bike mechanic.

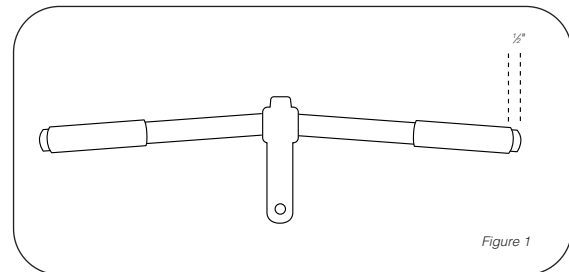

Figure 1

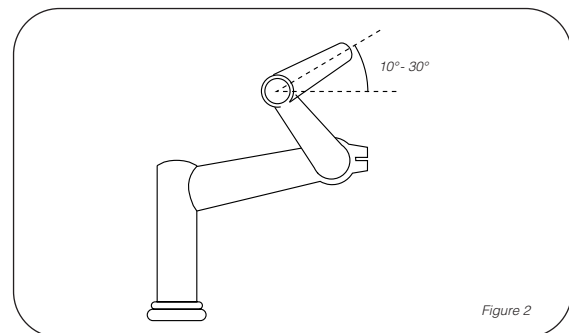

Figure 2



Chapel Hill, NC

Made in Taiwan, V.1 – May 2002