

# XPORT<sup>™</sup>

## 2" Extender

Thank you for purchasing the XPORT Extender. When used with the XPORT 2" Receiver Foot this Extender allows installation of the XPORT Passage or XPORT Traveler Uprights on vehicles requiring additional clearance (particularly those with a rear mounted spare tire, a step bumper, or a recessed hitch).

Please read all instructions for Assembly and Installation to Vehicle before using your XPORT Hitch rack.

Note:

The minimum vehicle hitch requirement is a Class 1, bolted to the chassis.

**CAUTION: IT IS THE USER'S RESPONSIBILITY TO INSURE THE SAFE AND PROPER USE OF THIS PRODUCT!**

Improper attachment or misuse of this Hitch Foot or rack may result in damage to the bicycles, your vehicle or the vehicles behind you on the road.

### Contents

Part	Part Code	QTY
XPORT Extender	A	1
5/8" Hitch Bolt	B	1
Washer	C	1

### Installation

- Slide the XPORT Extender into your vehicle's 2" receiver hitch and align the nut with the pin hole in the hitch.
- Install the Hitch Bolt and washer. Tighten securely.
- Slide the XPORT Hitch Foot into the Extender and align the Clevis Pin hole in the Foot with Hole 1 in the Extender. Whenever possible, use Hole 1 to mount your rack, keeping your bikes as close as possible to your vehicle. If extra clearance is necessary, slide the Foot back until the Clevis Pin hole aligns with Hole 2.
- Install the Clevis Pin and Clevis Pin Clip and tighten the Hitch Foot Knob securely, as specified in your XPORT 2" Hitch Foot instructions.

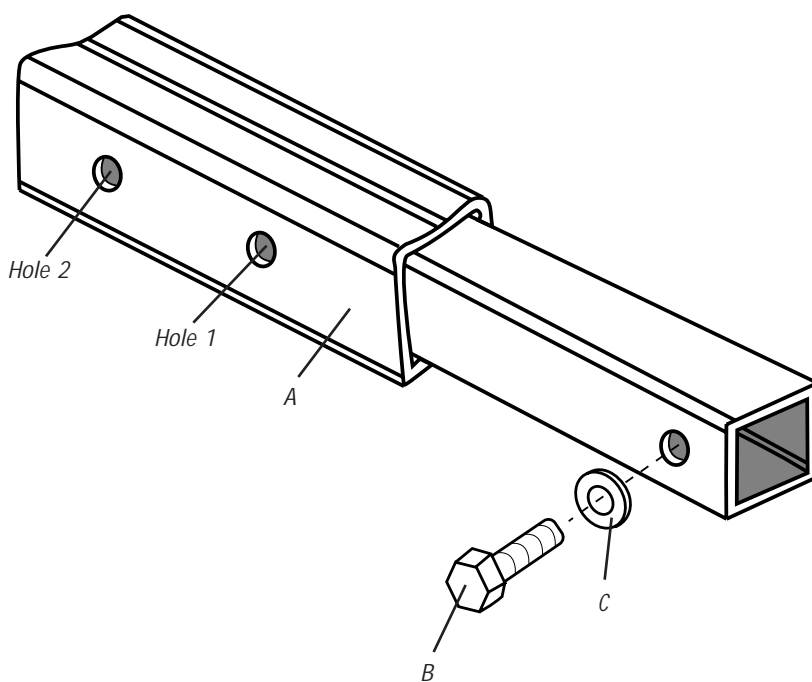

### Use

Check the tightness of the Hitch Bolt and Hitch Foot Knob before every trip. It is recommended to remove the Extender from your vehicle when not in use.

**Performance Tech Support 1 (800) 727-2453**  
**9am-6pm EST Monday-Friday**

 Performance, Inc.  
 One Performance Way  
 Chapel Hill, NC 27514  
 Made in USA  
[www.performancebike.com](http://www.performancebike.com)