

Tech Support Line
1-800-727-2453
0302_1

installation

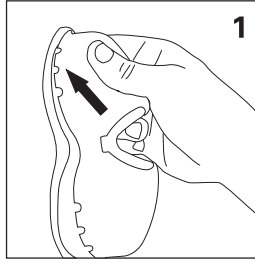

Radial II lens installation



Step 1
Insert the corner of the lens into the frame at the temple.

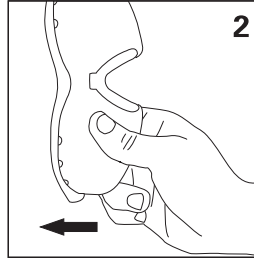

Step 2
Insert the other corner of the lens the same way.

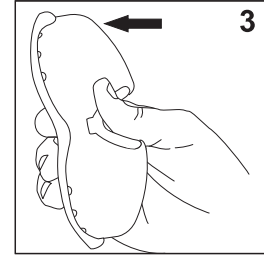

Step 3
While holding the frame and lens, apply pressure to the center of the lens until it snaps into the bridge.

Tech Support Line
1-800-727-2453
0302_1

removal



Radial II lens removal

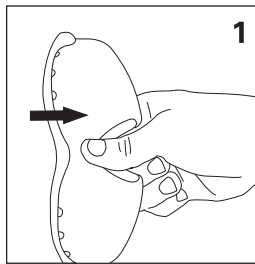

Step 1
Grip the lens near the bridge, and pull out to remove the lens.

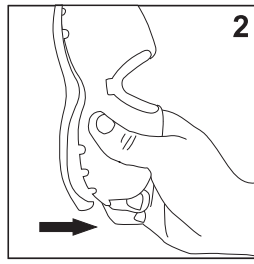

Step 2
Grip the lens near the temple, and pull the corner of the lens out from the frame.

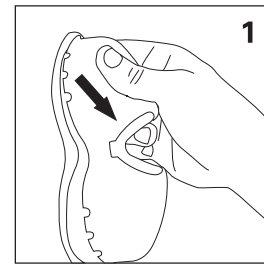

Step 3
Remove the other corner of the lens in the same way.