

# XPORT™ Xpress Truck Rack

Thank you for purchasing the XPORT Xpress Truck Rack bicycle carrier. This rack is designed to carry up to three road or mountain bikes or two tandem bikes. Hardware included with the Xpress Truck Rack will accommodate two road or mountain bikes. Additional front fork mounts and optional wheel carriers are available separately.

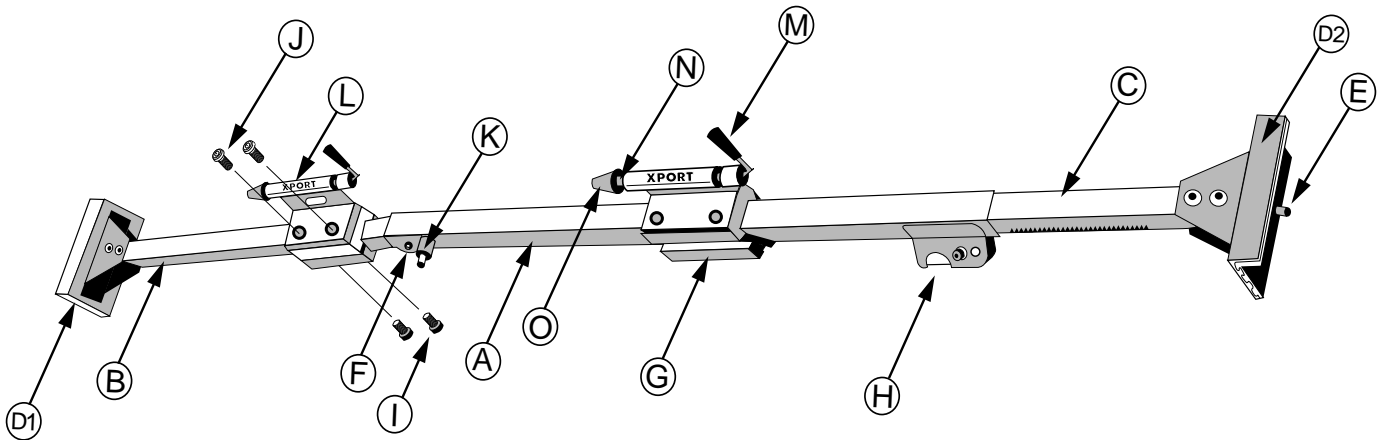

## Assembly Instructions

The majority of the XPORT Xpress Truck Rack has been pre-assembled. However, the following steps must be completed before the rack is installed

### Positioning Fork Mount Blocks

1. The Fork Mount Blocks (**G**) have been attached to the Main Tube (**A**) and Pivot Tube (**B**). To reposition the blocks (if desired), loosen the two 4mm hex bolts (**I**) that secure the block in place, slide the block along the tube to the desired position, and securely retighten the hex bolts (do not over-tighten).
2. To move a Fork Mount Block from the smaller diameter Pivot Tube to the larger diameter Main Tube (or vice versa), remove both 4mm hex bolts completely. Slide the upper half of the Fork Mount Block into the appropriate hinge slot (**see figure 1**), position the block in the desired location, and securely retighten the hex bolts (do not over-tighten).

## Parts Included

- A. Main Tube (1)
- B. Pivot Tube (1)
- C. Adjusting Tube (1)
- D. End Plates (2)
- E. End Plate Pins (2)
- F. Spring Pin (1)
- G. Fork Mount Block (2)
- H. Spring Lever (1)
- I. 4mm Hex Bolts
- J. 5mm Hex Bolts
- K. Lock Pin
- L. Universal Bike Mount (2)
- M. Quick Release Lever (2)
- N. Quick Release Skewer (2)
- O. Quick Release Nut (2)

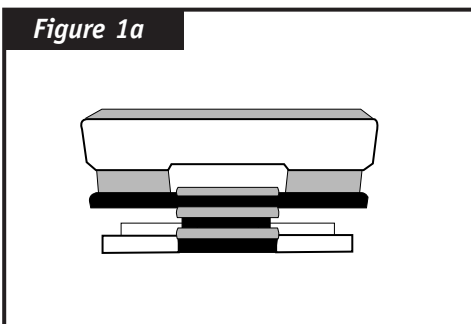

Correct position for mounting to Main Tube

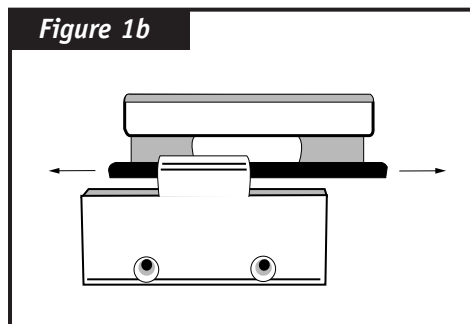

Slide to insert or remove

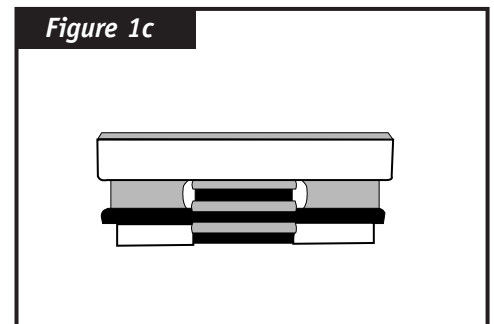

Correct position for mounting to Pivot Tube

## Attaching Universal Bike Mount

1. Attach one Universal Bike Mount (**K**) to each Fork Mount Block using the included 5mm hex bolts (**J**) (see figure 2).

### ⚠ CAUTION

Ensure all rack hardware is tightened securely before attaching rack to vehicle.

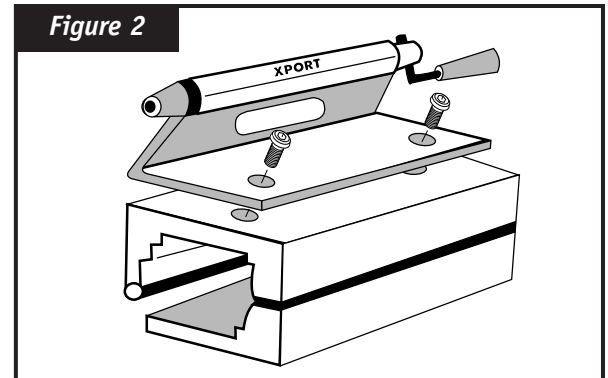

Figure 2

## Installation Instructions

For trucks with bed liners, begin with step 1. For trucks without a bed liner, proceed to step 3.

### ⚠ CAUTION

Do not install this rack in a truck with a bed liner unless you have made the following modifications

1. Install one End Plate Pin (**E**) in each End Plate (**D**) as shown in figure 3.
2. Drill a 3/8" hole in each side of the bed liner as shown in figure 4. Both holes should be drilled an equal distance from the front of the truck bed (approximately 12" from the front of the bed).
3. Make sure the truck bedrail or bed liner is clean, dry and free of oil or other lubricants. Compress the Spring Lever (**H**), and slide the Adjusting Tube (**C**) all the way into the Main Tube (**A**).
4. Stand in the truck bed near the cab. Hold the rack by the Main Tube, with the Spring Lever pointed downward and to the rear of the truck. Depress the Spring Pin (**F**) to open the rack, and allow the Pivot Tube (**B**) to pivot downward (see figure 5a and 5b). Be careful not to pinch your fingers or hands.
5. Place the Pivot Tube's End Plate (**D1**) against the driver's side bedrail, approximately 12" from the front of the bed.
6. With the rack still in the open position (figure 5b), slide the Adjusting Tube out of the Main Tube until it makes firm contact with the passenger's side bedrail. Both End Plates should sit squarely against the bedrails, so that the rack is perpendicular to the bed walls (see figure 5c).

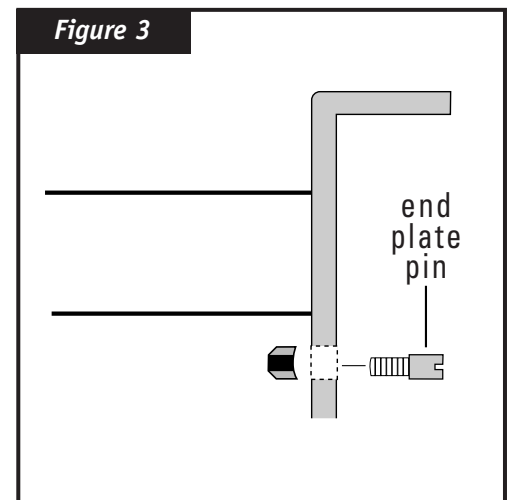

Figure 3

### ⚠ CAUTION

When installing rack in a truck with a bed liner, ensure end plate pins are inserted in bed liner holes drilled in Step 1.

7. Push down on the center of the Main Tube to close the rack. Keep hands and fingers away from the pivot location to avoid pinching.
8. Check to see that the Spring Pin (**F**) has snapped through the hole in the Main Tube, indicating that the rack is fully closed.
9. Ensure that the rack is secure by pushing and pulling forward and backward on the rack. The rack is securely installed if you can rock the truck without causing the End Plates to slip. If slippage occurs, reinstall the rack following steps 3-8, and test again.

### ⚠ CAUTION

Check to ensure that rack is securely attached to vehicle and that all rack hardware is securely tightened before every use.

10. The Xpress Truck Rack features an integrated lock to secure the rack in the truck bed. To lock, press the Lock Pin (**K**). Record your key number and keep it in a safe place in the event that replacement keys are needed. To order replacement keys call 1-800-727-2453.
11. The integrated lock does not secure the bikes to the rack. Use separate cable locks or other methods to lock the bikes to the rack or the vehicle.

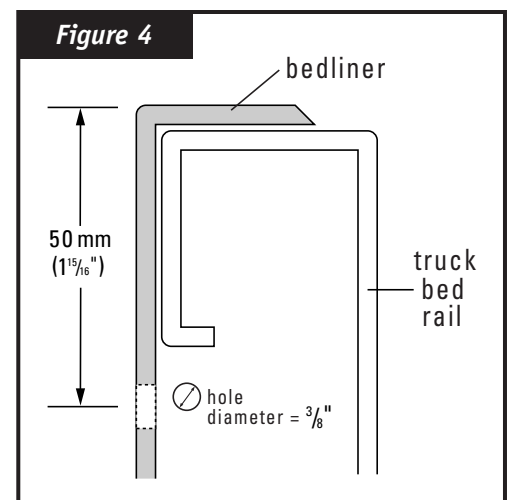

Figure 4

Figure 5a

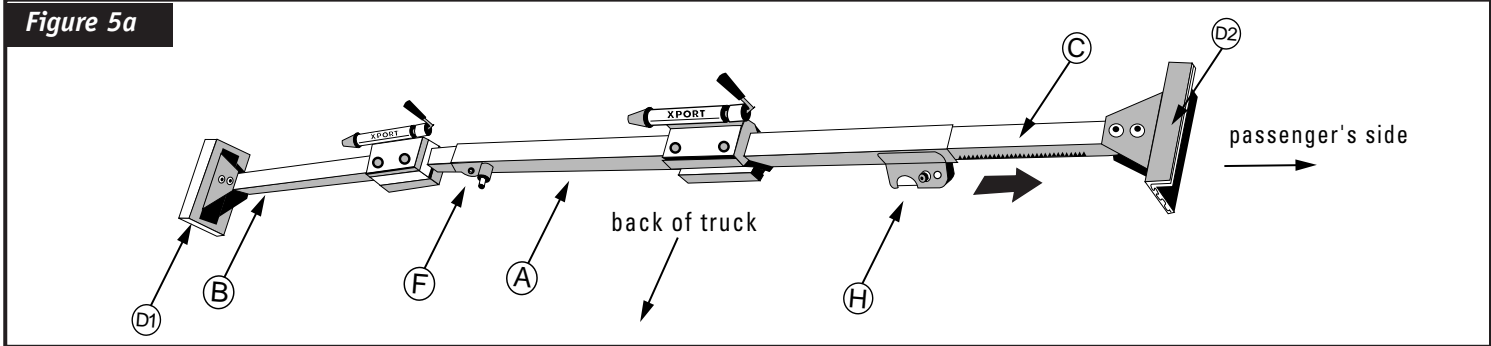

Figure 5b

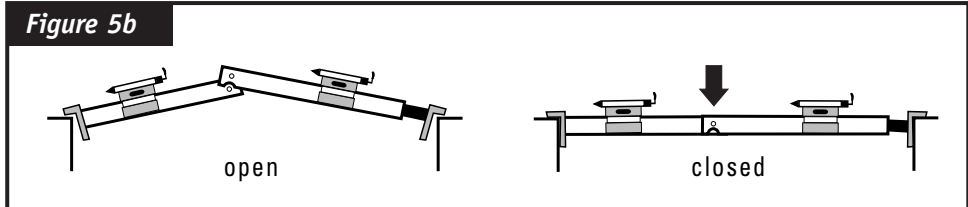
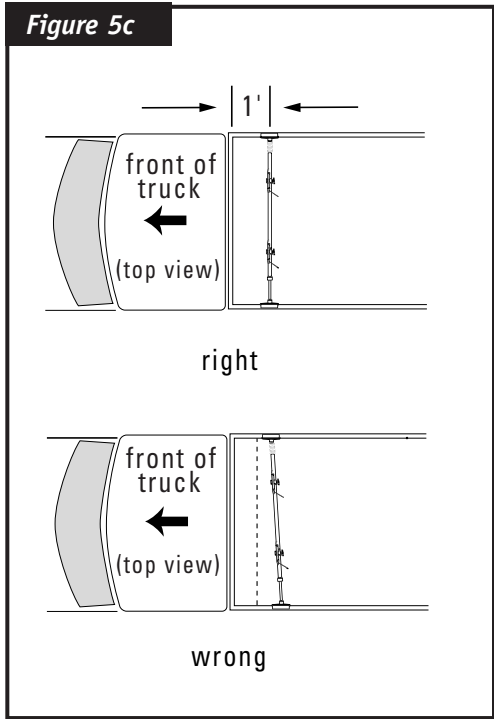

Figure 5c



**CAUTION**

Locks deter theft but cannot guarantee security. If theft is a concern, do not leave rack or bikes unattended. Remove rack and bikes, and store in a secure location.

### Removal Instructions

1. Remove all bikes and wheels from the rack.
2. Unlock rack. Insert key, turn 360° and remove key. The Lock Pin will protrude from the lock in the unlocked position.
3. Depress the Spring Pin (F). With the Spring Pin depressed, pull up on the center of the Main Tube until the rack pops open. Be careful not to pinch fingers or hands when opening the rack. Lift the rack out of the truck.

**DO NOT OPEN THE RACK BY DEPRESSING THE SPRING LEVER WITHOUT FIRST RELEASING THE SPRING PIN.**

### Installing Bikes

1. It is very important to properly secure the front fork of the bicycle to the Universal Bike Mount (L). Failure to do so may result in damage to the bike, to the vehicle or to following cars.
2. Move the Quick Release Lever (M) to the OPEN position (see figure 6), and place the fork onto the Quick Release Skewer (N).
3. Tighten the Quick Release Nut (O) by hand until it can no longer be turned, and is firmly against the fork.
4. Push the Quick Release Lever to the CLOSE position (see figure 6). Be sure to push the Quick Release Lever all the way to the CLOSE position. If the Quick Release Lever can easily be pushed to the CLOSE position, it is not sufficiently tight. Open the Quick Release Lever and tighten the Quick Release Nut an additional 1/8 to 1/4 turn to increase clamping strength. Close the Quick Release Lever again and recheck tightness. Repeat this process until the Quick Release Lever closes with sufficient resistance to leave a small imprint on the palm of your hand. If the lever will not close completely, loosen the Quick Release Nut 1/8 to 1/4 turn and try again. Repeat as necessary to achieve correct tightness.
5. Ensure that the bike is secure by pulling up on the handlebar. If slippage occurs, remove the bike and repeat steps 2-4.

**DO NOT USE A DAMAGED OR BENT QUICK RELEASE SKEWER. REPLACE DAMAGED QUICK RELEASE SKEWERS IMMEDIATELY.**

Figure 6

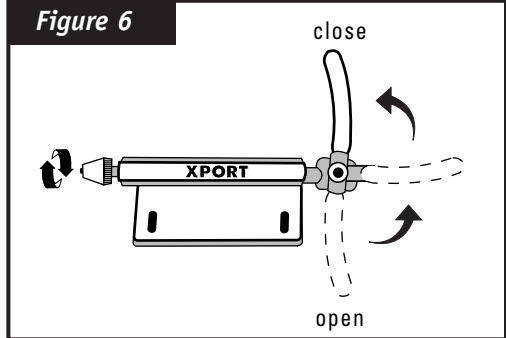

### ⚠ CAUTION

1. Always keep tailgate closed or retaining net in place when using rack.
2. Check to ensure all rack hardware is securely tightened and rack is securely attached to vehicle before every use.
3. Check to ensure bicycles and wheels are securely attached to rack before driving vehicle.
4. Check End Plate pads for wear periodically. Worn or torn pads could cause the rack to slip, and should be replaced.
5. The Xpress Truck Rack will hold a maximum of three single rider bicycles or two tandem bicycles. Do not overload rack.
6. Due to increased wind resistance, it is advisable to remove child seats, panniers, wheel covers or full bike covers from bicycles during transport.
7. To avoid personal injury, do not ride in the truck bed with the rack installed.

**PERFORMANCE**

# XPORT™ Xpress Truck Rack Wheel Carrier

Thank you for purchasing the XPORT Xpress Truck Rack Wheel Carrier. This carrier allows you to carry a front or rear wheel safely protected from other cargo.

## Installation Instructions

1. Determine whether the Wheel Carrier is to be mounted on the larger diameter Main Tube or the smaller diameter Pivot Tube, and orient the Tube Sleeve accordingly (see figure 7).
2. Snap the Tube Sleeve (B) onto the Main Tube or Pivot Tube in the desired location, so that when the Wheel Carrier clamp is closed, the slot in the Tube Sleeve will be aligned with the clamp opening (see figure 7).
3. Close the Wheel Carrier clamp around the Tube Sleeve, and install the Assembly Bolt and Assembly Knob as shown in figure 8.
4. Tighten the Assembly Knob securely, but do not over-tighten.
5. Mount the wheel to be carried in the Wheel Carrier by installing your wheel's quick release skewer in the Wheel Carrier drop outs, and closing the wheel's quick release lever securely. It may be necessary to adjust the tightness of your quick release skewer to fit securely in the wheel carrier.
6. Check to ensure the wheel is installed securely by pulling up on the wheel. If any slippage occurs, recheck the security of the wheel's quick release lever.

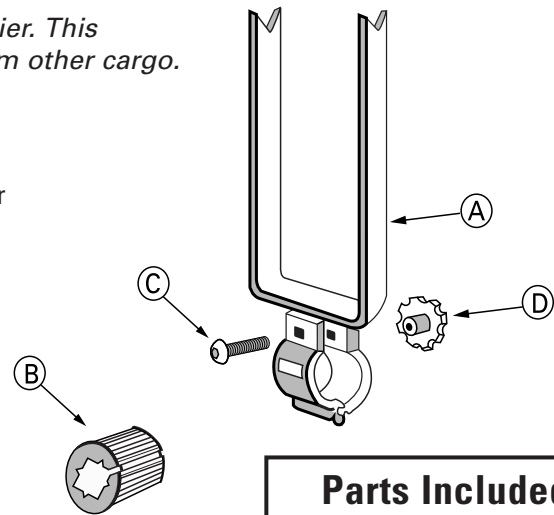

### Parts Included

- A. Wheel Carrier (1)
- B. Tube Sleeve (1)
- C. Assembly Bolt (1)
- D. Assembly Knob (1)

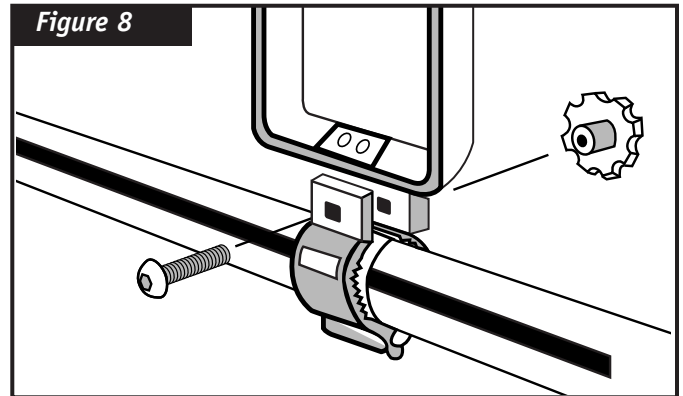
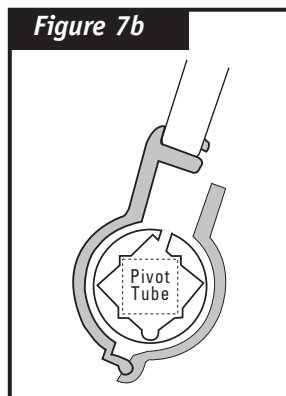
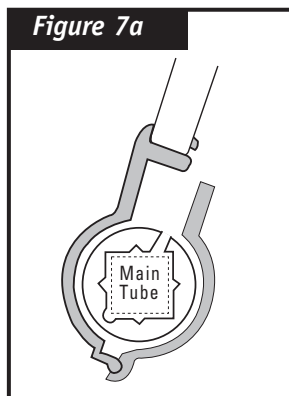

**Performance, Inc.**  
One Performance Way  
Chapel Hill, N.C. 27514  
Made in Taiwan  
PerformanceBike.com  
PERFORMANCE and the Flying P Logo are  
registered marks of Performance Inc.

**Performance Tech Support 1(800)727-2453 9am-6pm EST Monday-Friday**